

SCRIPT

SECTOR: CONNECTION PLANS IN ELECTRONIC ENGINEERING
IN GERMANY

TOPIC: LEARN THE MOST IMPORTANT FACTS ABOUT THE
CABLING SYSTEM IN GERMANY
AND LEARN THE MOST IMPORTANT VOCABULARY.

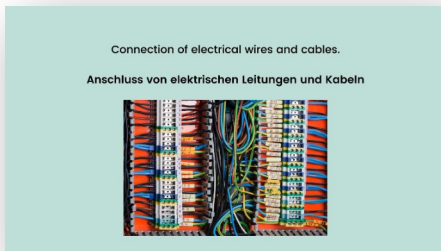

Connection of electrical wires and cables.

[Anschluss von elektrischen Leitungen und Kabeln.](#)

This is what you should know ...when you connect or join wires in electrical installations.



Cables can be used to transmit data in the form of electrical signals: [Datenleitung](#).



Or they can be used to supply electrical energy to sockets or luminaires: [Mantelleitung](#).



In Germany, type F sockets are used. In German socket is called: [Steckdose](#).



Let's take a closer look at two sheathed cables for electrical power supply. We remove the sheath insulation with a stripper [Entmantler](#) without damaging the cores.

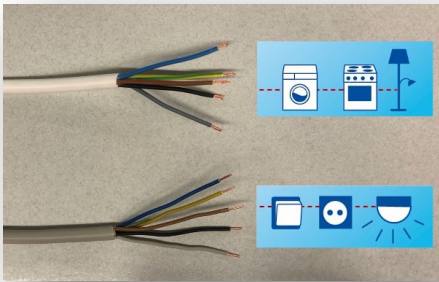

One of the cables has single-wire rigid copper cores. The other has finely stranded flexible copper cores.

[starre Kupfer-Adern](#)

[flexible Kupfer-Adern](#)

The cores of both cables have the same cross section:

[Querschnitt](#).

They can therefore be loaded with the same current.

Cables with rigid copper cores are used for fixed installation, for example in the wall.

Distribution cabinet

Verteilerkasten



Cables with flexible copper cores are used for connecting movable devices or as individual cores in a distribution cabinet: [Verteilerkasten](#).

What must be observed when connecting the cores: [Adern?](#)

Earthing contact plug - Schukoadapter

Wire end sleeves - Aderendhülse



Rule 1 - Connection to screw connections:

Rigid copper wires can be connected directly to the screw connections of the earthing contact plug.

Earthing contact plug – colloquially [Schukoadapter](#).

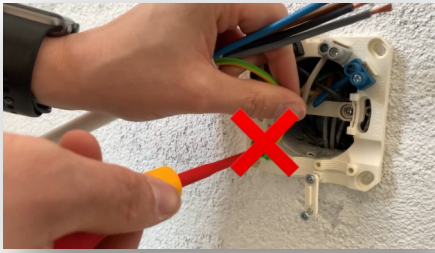

Flexible copper cores must NOT be connected directly to the screw connections of the Schuko plug.



Wire end sleeves must be pressed onto flexible copper wires with crimping pliers: [Aderendhülse](#).
This ensures a permanent connection!

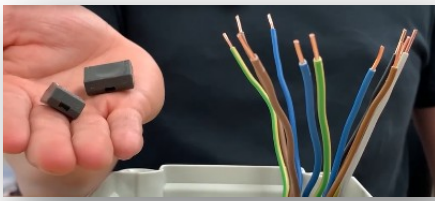

Rule 2 - Connection in plug-in terminals:
Rigid copper wires can be plugged directly into connecting terminals: [Steckklemme](#).



Connection terminals - colloquially known as Wago terminals.
There are special connecting terminals for flexible copper wires: [Federkraftklemme](#).

Create a secure connection and stay connected!

LIST OF VOCABULARY

SECTOR: CONNECTION PLANS IN ELECTRONIC ENGINEERING
IN GERMANY

TOPIC: LEARN THE MOST IMPORTANT FACTS ABOUT THE
CABLING SYSTEM IN GERMANY
AND LEARN THE MOST IMPORTANT VOCABULARY.

GERMAN	YOUR LANGUAGE
<i>Anschluss von elektrischen Leitungen und Kabeln</i>	
<i>Datenleitung</i>	
<i>Mantelleitung</i>	
<i>Steckdose</i>	
<i>Entmantler</i>	
<i>starre Kupfer-Adern</i>	
<i>flexible Kupfer-Adern</i>	
<i>Querschnitt</i>	
<i>Verteilerkasten</i>	
<i>Adern</i>	
<i>Schukoadapter</i>	
<i>Aderendhülse</i>	
<i>Steckklemme</i>	
<i>Federkraftklemme</i>	